

002

W.C. Layouts and Details
 Refer to drawings sheet 00 for details of W.C. partition construction, plumbing and extraction.

Steel Intumescent Fire Protection
 Test existing paint finish to central steel column and double cross steel beams as specified by THERMOGUARD UK LTD 'Previously Painted Existing Steelwork'.
 Complete THERMOGUARD 'Request for Certificate of Supply' document allowing for THERMAGUARD to calculate and supply the appropriate intumescent coating required to give 60 minute fire protection.
 On completion a CERTIFICATE OF SUPPLY must be issued by THERMOGAURD for submission to Building Control.
 Apply all intumescent coats as to manufacturers instructions.

60 Minute Fire Boarding to Ceiling
 Apply to the underside of all joists Two (2) layers of 15mm GYPROC FIRELINE BOARD to be fixed with staggered joints as to manufacturers instructions.
 Ensure that both layers of boarding are cut and fixed TIGHT against all perimeter walls, internal walls, columns and beams. The second layer of boarding shall have all joints tape jointed and sealed (this is not required on the first layer).
 Where the boarding abuts into the perimeter wall, internal walls, columns and beams then that butt joint shall be finished with an INTUMESCENT MASTIC FILLER.

Emergency Key:

FD30	Half Hour Fire Door (Self Closing)
FE	Final Exit Door
FB	Fire Blanket
⊠	Fire Alarm Call Point
⊠	Foam Fire Extinguisher
⊠	CO ² Fire Extinguisher
⊠	Fire Notice
⊠	Emergency Light Fitting
CM	Carbon Monoxide Alarm Subject to Boiler Position
⊠	Smoke Detector with Sounder Linked to Fire Alarm System
HD	Heat Detector Not Linked to Fire Alarm System
⊠	Fire Door Keep Shut Sign
⊠	Alarm Sounder
FP	Fire Panel (to be located in the ground floor entrance lobby).
DS	Directional Signage

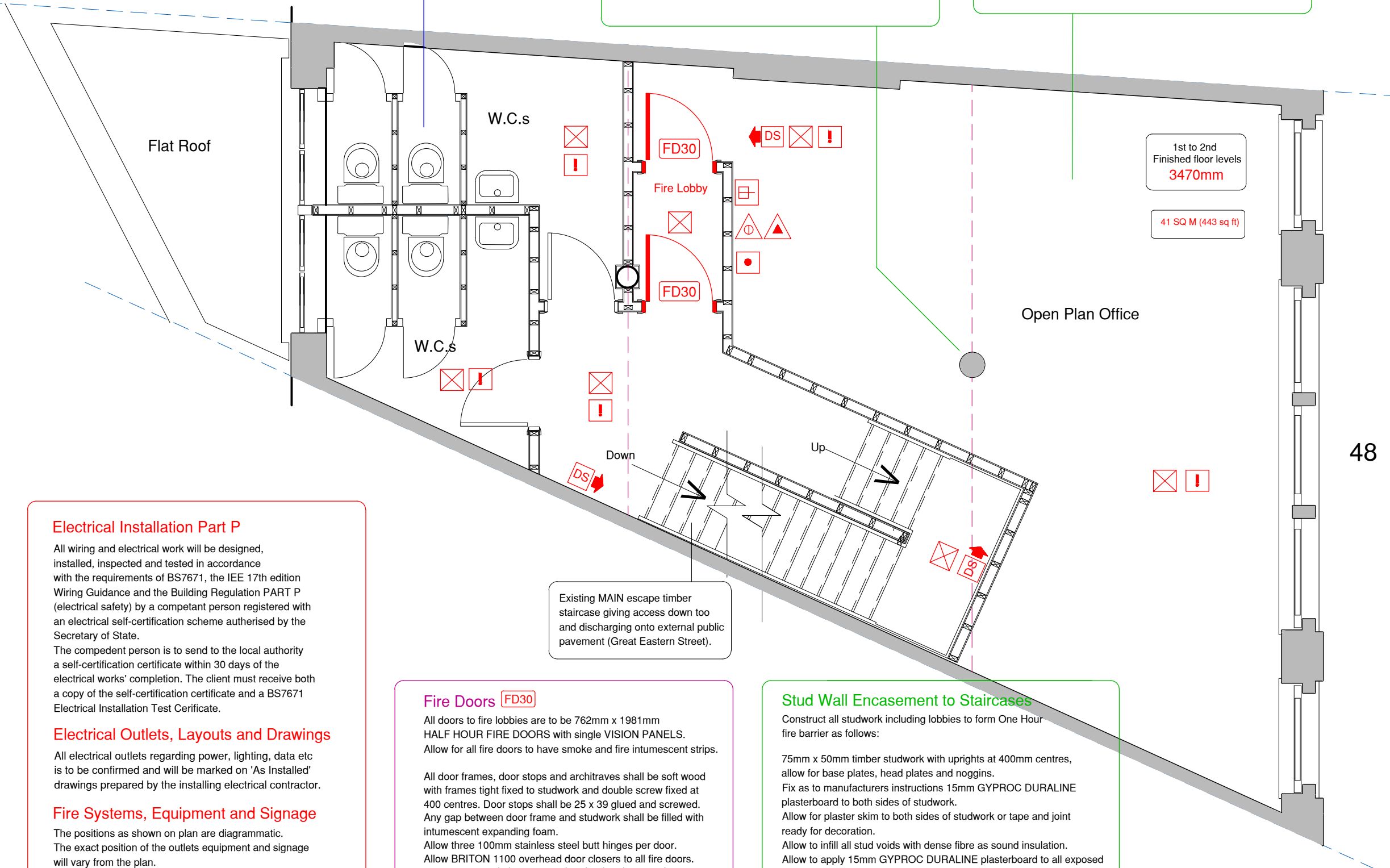

Electrical Installation Part P
 All wiring and electrical work will be designed, installed, inspected and tested in accordance with the requirements of BS7671, the IEE 17th edition Wiring Guidance and the Building Regulation PART P (electrical safety) by a competent person registered with an electrical self-certification scheme authorised by the Secretary of State.
 The competent person is to send to the local authority a self-certification certificate within 30 days of the electrical works' completion. The client must receive both a copy of the self-certification certificate and a BS7671 Electrical Installation Test Certificate.

Electrical Outlets, Layouts and Drawings
 All electrical outlets regarding power, lighting, data etc is to be confirmed and will be marked on 'As Installed' drawings prepared by the installing electrical contractor.

Fire Systems, Equipment and Signage
 The positions as shown on plan are diagrammatic. The exact position of the outlets equipment and signage will vary from the plan.

Fire Doors FD30
 All doors to fire lobbies are to be 762mm x 1981mm HALF HOUR FIRE DOORS with single VISION PANELS. Allow for all fire doors to have smoke and fire intumescent strips.
 All door frames, door stops and architraves shall be soft wood with frames tight fixed to studwork and double screw fixed at 400 centres. Door stops shall be 25 x 39 glued and screwed. Any gap between door frame and studwork shall be filled with intumescent expanding foam.
 Allow three 100mm stainless steel butt hinges per door. Allow BRITON 1100 overhead door closers to all fire doors. 25mm x 39mm timber stops to be glued and screwed.

Stud Wall Encasement to Staircases
 Construct all studwork including lobbies to form One Hour fire barrier as follows:
 75mm x 50mm timber studwork with uprights at 400mm centres, allow for base plates, head plates and noggins.
 Fix as to manufacturers instructions 15mm GYPROC DURALINE plasterboard to both sides of studwork.
 Allow for plaster skim to both sides of studwork or tape and joint ready for decoration.
 Allow to infill all stud voids with dense fibre as sound insulation.
 Allow to apply 15mm GYPROC DURALINE plasterboard to all exposed staircase soffits.
 All studwork to be constructed up to the fire rated plasterboard ceiling.

Proposed First Floor Plan

Robert Nall Design
 27 Meadow Close, Raynes Park, London, SW20 9JB
 Tel: 020 8540 8605
 robertnall@hotmail.co.uk

Project Name
**48 Great Eastern Street
 London EC2 A 3EP**

Project No
2016/05/GES

Scale
 1-25 (A1) 1-50 (A3)

Checked by
RTN

Drawing Name
Proposed First Floor Plan

Drawing No
002

Date
25.03.16